

CHERRY H781A-456

A NEW COMPACT OFFSET PULLING HEAD FOR AEROSPACE APPLICATIONS



The Cherry® brand H781A-456 is a new compact offset pulling head, replacing the popular H781-456 model. Its very compact size, light weight, improved strength and reliability together with some unique new features make it ideal for a diverse range of applications including installing fasteners in restricted spaces. This pulling head will work directly with G746A, G747, G704B, G704B-40SH, G704B-SR, G800 and similar riveters. With appropriate adapters, other riveter models may be used (see TS-H781A-456 for details).

FEATURES AND BENEFITS

Versatility

Increased usable stroke for installing longer grip fasteners (when used with a long stroke riveter). Its fastener capability include (but is not limited to):

- Cherrymax® (-4,-5 & -6 nominal and oversize diameters, all grips and materials)
- Cherrymax® AB (-4,-5 & -6 nominal and oversize diameters, all materials-including all aluminum)
- Maxibolt® S type (-4 and -5 diameters, all grips and materials)
- MBC® L/C (lock creator type, -4, -5 and -6 diameters, all materials)
- NAS1900 "U" (-4, -5 and -6 diameters, all materials)

Lower operating cost and improved reliability

- An improved jaw system with better serration engagement and easy jaw grip force adjustment for longer tool life and to prevent slippage when installing smaller diameter stems.
- Lower cost wear items (jaw system)

Backwards compatibility

- The new and improved Jaw / Saddle system (781-004 and 781-005 respectively) are compatible with the previous model, H781-456.

Ergonomic Design

More compact and lighter envelope allows access in even more restricted installation areas.

1224 East Warner Ave, Santa Ana, CA 92705

Tel: 1-714-545-5511 Fax: 1-714-850-6093

www.cherryaerospace.com

CA-1051, Rev -, DCR 15-1084, Date: 10/21/15



CHERRY®
AEROSPACE

CHERRY H781A-456

A NEW COMPACT OFFSET PULLING HEAD FOR AEROSPACE APPLICATIONS

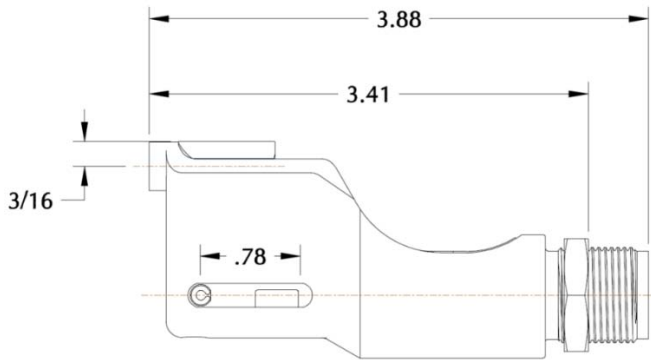

H781A-456 (new design)

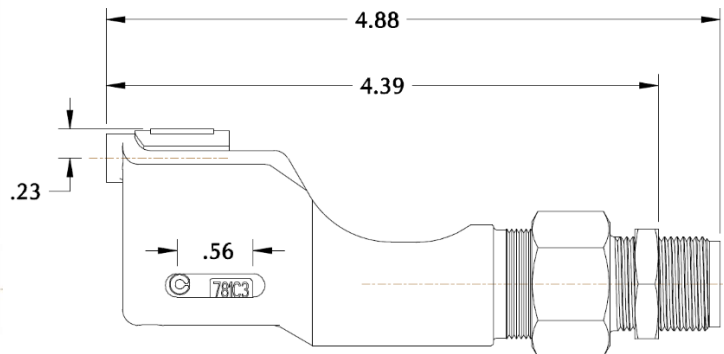

H781-456 (previous model)

TECHNICAL SPECIFICATIONS

PART NUMBER:	H781A-456
MAXIMUM STROKE:	3/4"
MAXIMUM POWER:	3500 LbsF.
WEIGHT:	1/2 Lb.
MOUNTING SYSTEM	Cherrymax® (Ex: G746A, G747, G704B)

